

# RQ-011 – Upright Flying Lead Orientation Tool

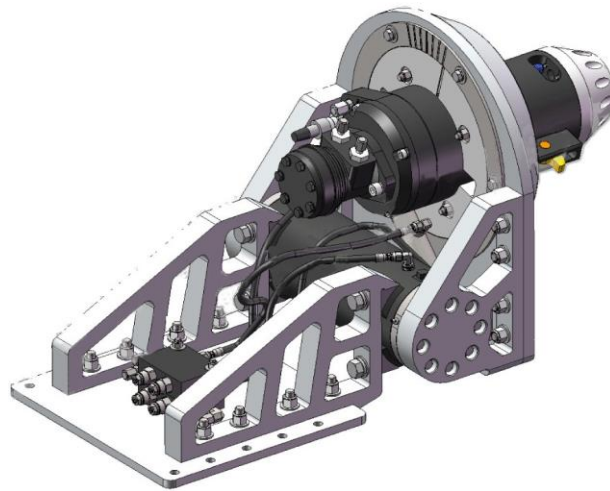

## Key Features:

- +/- 15 deg roll angle
- plus 60 minus 90 deg pitch
- Counterbalance Valve on both actuators.
- 250kg Payload
- Supplied in Transit Case

## WHATS INCLUDED

FLOT.  
Adaptor to fit Forum Torque Tool.  
Operational hoses.  
Operations Manual.

## OPTIONS

Torque Tools.  
TTCS.  
Verification Units.

## Description

The Forum Subsea FLOT tool is designed to operate in conjunction with a torque tool and is used to orientate and guide flying leads into the stab plate connections.

The FLOT tool is designed to take the FORUM Class 1-4 torque tool but can easily accommodate similar tools from other manufacturers.

A rotary actuator allows a pitch alignment of plus 60 or minus 90 degrees with a load of up to 250kg attached. The tool is also equipped with a roll alignment function giving a rotation of plus or minus 15 degrees

The FLOT tool is compact and the tool mounting base is supplied with a selection of mounting holes for mounting within the forward structure of the ROV.

The pitch and roll actuators are controlled from the ROV's spare directional control valves.

# RQ-011 – Upright Flying Lead Orientation Tool

Overall Specifications	
Weight in air/water:	77 kg/57 kg (169 lbs/125lbs) (excl torque tool)
Pitch:	+ 60 / - 90 degrees
Rotation:	+/- 15 degrees
Payload Capacity:	250kg (550lb) mounted on torque tool, through full range of travel.
Hydraulic control from ROV:	Two-off bi-directional solenoid control valves plus drain
Operating Fluid:	Hydraulic Oil
Operating Pressure:	207 bar (3000 psi)
Hydraulic Fittings:	JIC or Swagelok

## WHATS INCLUDED

- FLOT.
- Adaptor to fit Forum Torque Tool.
- Operational hoses.
- Operations Manual.

## OPTIONS

- Torque Tools.
- TTCS.
- Verification Units.

